

Stihl MS 261 Chainsaws



| REF. | PART NO. | DESCRIPTION | REPLACES |
|------|----------|---|-------------------------------------|
| 1. | 605-205 | Air Filter | Stihl 1141 120 1600 |
| 2. | 090-3607 | Silver Streak Chain Loop Semi-Chisel | 3/8" Pitch, .050 Gauge, 60 DL |
| 3. | 090-3667 | Silver Streak Chain Loop Semi-Chisel | 3/8" Pitch, .050 Gauge, 66 DL |
| 4. | 096-5677 | Silver Streak Chain Loop Semi-Chisel | .325" Pitch, .063 Gauge, 67 DL |
| 5. | 090-3727 | Silver Streak Chain Loop Semi-Chisel | 3/8" Pitch, .050 Gauge, 72 DL |
| 6. | 096-5747 | Silver Streak Chain Loop Semi-Chisel | .325" Pitch, .063 Gauge, 74 DL |
| 7. | 096-5817 | Silver Streak Chain Loop Semi-Chisel | .325" Pitch, .063 Gauge, 81 DL |
| 8. | 632-540 | Cylinder Assembly | Stihl 1141 020 1200 |
| 9. | 705-224 | Bar Guard | 16" |
| 10. | 705-222 | Bar Guard | 20" |
| 11. | 075-1607 | Silver Streak Replaceable Spr. Nose Bar | 16", .325" Pitch, .063 Gauge, 67 DL |
| 12. | 075-1617 | Silver Streak Replaceable Spr. Nose Bar | 16", 3/8" Pitch, .050 Gauge, 60 DL |
| 13. | 075-1807 | Silver Streak Replaceable Spr. Nose Bar | 18", .325" Pitch, .063 Gauge, 74 DL |
| 14. | 075-1817 | Silver Streak Replaceable Spr. Nose Bar | 18", 3/8" Pitch, .050 Gauge, 66 DL |
| 15. | 075-2027 | Silver Streak Replaceable Spr. Nose Bar | 20", 3/8" Pitch, .050 Gauge, 72 DL |
| 16. | 075-2007 | Silver Streak Replaceable Spr. Nose Bar | 20", .325" Pitch, .063 Gauge, 81 DL |
| 17. | 630-107 | Starter Pawl (case of 2) | Stihl 1125 195 7200 |
| 18. | 630-111 | Spring Clip (case of 2) | Stihl 1128 195 3500 |
| 19. | 416-350 | Screw (case of 5) | Stihl 9022 371 1020 |
| 20. | 635-250 | Bumper Strip | Stihl 1121 648 6610 |
| 21. | 135-519 | Spark Plug Boot | Stihl 1106 405 1000 |
| 22. | 635-361 | Chain Adjuster | Stihl 1125 007 1021 |
| 23. | 646-425 | Clutch Assembly | Stihl 1121 160 2051 |
| 24. | 635-374 | Worm Gear | Stihl 1121 640 7110 |
| 25. | 495-220 | Oil Seal (case of 5) | Stihl 9640 003 1600 |
| 26. | 495-201 | Oil Seal (case of 5) | Stihl 9640 003 1560 |
| 27. | 623-515 | Base Gasket | Stihl 1141 029 2302 |
| 28. | 635-190 | Cylindrical Pin | Stihl 9371 470 2640 |
| 29. | 485-104 | Muffler Gasket (case of 5) | Stihl 1141 149 1600 |

CONTINUED ON NEXT PAGE

CHAINSAW

* Net Priced Item

Stihl MS 261 Chainsaws (Cont.)

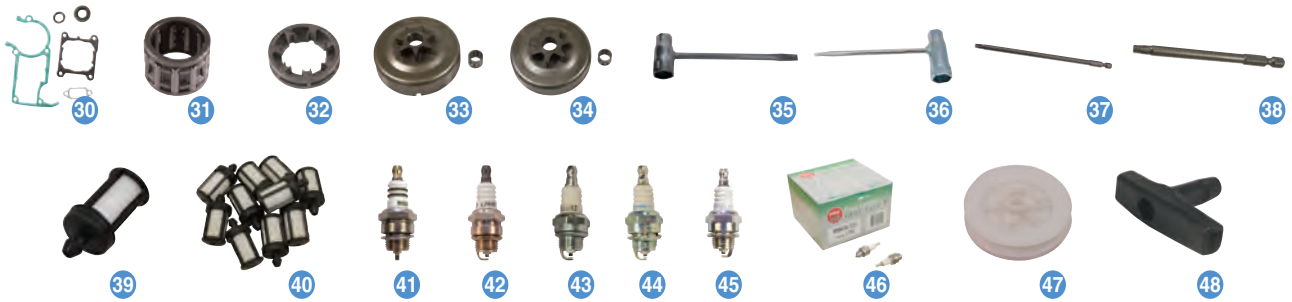

| REF. | PART NO. | DESCRIPTION | REPLACES |
|------|----------|---------------------------------------|---------------------------------|
| 30. | 480-372 | Gasket Set | Stihl 1141 007 1000 |
| 31. | 635-428 | Sprocket Bearing | Stihl 9512 933 2260 |
| 32. | 085-0217 | Silver Streak Rim Sprocket | .325" Pitch 7 Teeth Sm 7 Spline |
| 33. | 085-2177 | Silver Streak Pro Spur Sprocket | .325" Pitch, 7 Teeth |
| 34. | 085-3247 | Silver Streak Pro Spur Sprocket | 3/8" Pitch, 7 Teeth |
| 35. | 705-574 | T-Wrench | 3/4" x 1/2" |
| 36. | 705-594 | Torx T-Wrench | Stihl 4119 890 3400 |
| 37. | 705-194 | T27 Power Bit 6" | Stihl 0812 540 1112 |
| 38. | 705-190 | T27 Power Bit 3 1/2" | Stihl 0812 540 1112 |
| 39. | 610-254 | Fuel Filter | Stihl 0000 350 3504 |
| 40. | 610-256 | Fuel Filter Shop Pack (case of 10) | Stihl 0000 350 3504 |
| 41. | 130-124 | Bosch Spark Plug | Bosch WSR6F |
| 42. | 131-023 | Torch Spark Plug | Torch L7RTC |
| 43. | 130-073 | Champion Spark Plug | Champion RCJ6Y |
| 44. | 130-898 | NGK Spark Plug | NGK BPMR7A |
| 45. | 130-204 | NGK Carded Spark Plug | NGK BPMR7A |
| 46. | 130-012 | NGK Spark Plug Shop Pack (case of 25) | NGK BPMR7A |
| 47. | 150-452 | Starter Pulley | Stihl 1128 195 0400 |
| 48. | 140-129 | Starter Handle | Stihl 1121 195 3400 |

CHAINSAW

* Net Priced Item

